

Instructions for use  
—Type 1 Fix



## Type 1 button-fix

The Button-fix concept is simple: the Fixes are attached to the back of one panel and the mating Buttons are attached to the other. Bring the panels together and slide until the Button-fixes ‘click’.

The Type 1 Button-fix is moulded in durable, glass-filled nylon. It connects parallel panels and its strength has been verified by an independent test house. It can be configured in many different ways to best suit your application, either surface-mounted or recessed into the panel, and orientated for vertical or sideways assembly.

Visit the website for more information on the complete Button-fix range, including videos of the Type 1 Button-fix in use. You can also obtain a new copy

of these instructions from the website in the event of loss or in the event that Buttonfix modifies the instructions.

Buttonfix Limited retains the right to modify the instructions as it deems appropriate and the consumer is responsible for checking the website for the latest information.

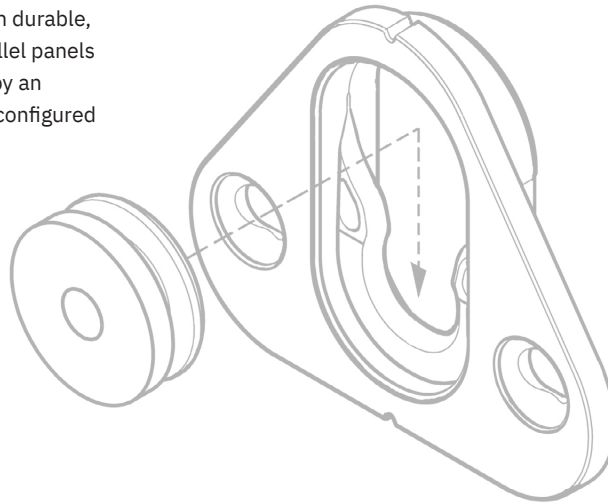

## Warnings

—Button-fix is intended for furniture construction and interior fittings and is not intended, nor should it be used, for any other purpose.

—**WARNING:** Serious damage to property and severe bodily injury can result from (1) improper use, application or installation of the Button-fix or (2) use as part of improperly designed or constructed assemblies or materials.

—Provided that the screws and substrate are properly matched, and all other instructions complied with, independent tests showed that a vertical panel fixed with four Type 1 Fixes can support loads weighing up to a maximum of 440lbs. For critical applications it is essential to perform your own tests.

—Avoid any contact with aggressive solvents and cleaning products.

—It is not possible for Buttonfix to warn the consumer about every possible danger related to use of the Button-fix and the consumer must use his or her own good judgment when installing and using the Button-fix.

## The button

There are two Buttons to suit different screw types. These are colour-coded lime green for #10 flat head wood screws, or orange for Ø6.2mm Varianta Euro screws (to fit Ø5mm pilot holes).

Check with your panel supplier which screw type is best for your application.

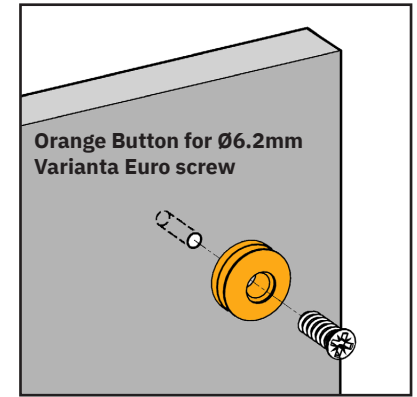
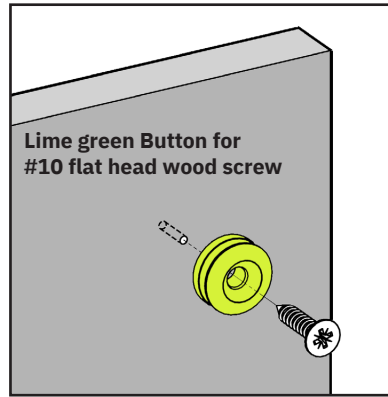

## Button marker accessory

The Button marker accessory helps to mark out where to install the Buttons.

Once you have attached the Fix mouldings (see following pages), snap a marker into each one. Then position the second panel and press firmly. The markers will leave indents in the panel surface, which can be used as guides for drilling pilot holes for the Buttons.

Remove the markers, which can be re-used to mark out the next panel.

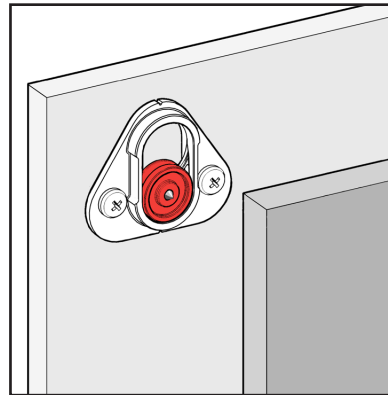

## Surface-mounted fix

Surface mounting creates an 0.31" gap between the two panels. The Fix can be configured in three options:

### 1. Button on removable panel

The Fix is attached to the background structure, pointing upwards as shown in the diagrams on the right.

In this configuration, the panels engage vertically and 0.6" clearance is required above the removable panel.

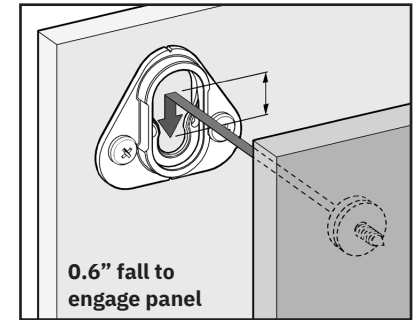
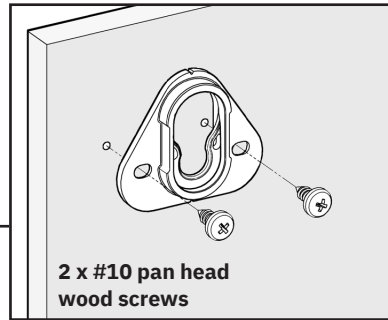

### 2. Fix on removable panel

The Fix is attached to the removable panel, pointing downwards as shown in the diagrams on the right.

In this configuration, the panels engage vertically and 0.6" clearance is required above the removable panel.

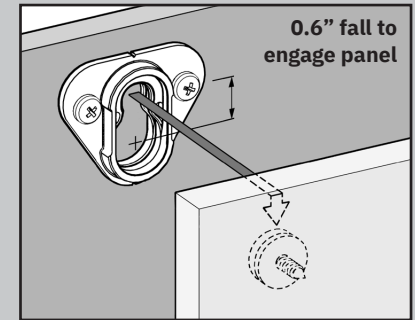
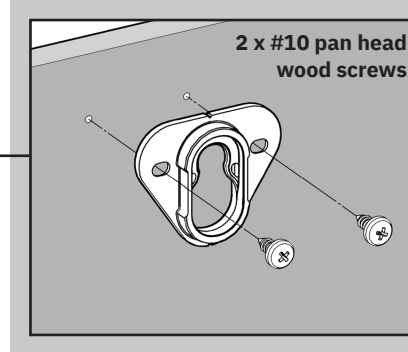

### 3. Sideways arrangement

The Fix is attached to either the background structure or the removable panel, pointing sideways as shown in the diagrams on the right.

In this configuration, the panels engage horizontally and 0.6" clearance is required to the side of the removable panel.

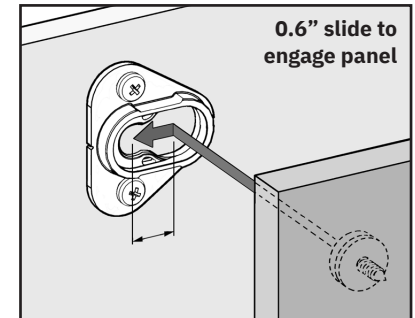
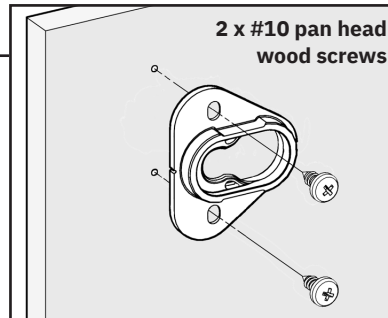

## Recessed fix

Recessing the Fix creates a 0.12" gap between the two panels. The Fix can be configured in three options:

### 1. Button on removable panel

The Fix is attached to the background structure, pointing upwards as shown in the diagrams on the right.

In this configuration, the panels engage vertically and 0.6" clearance is required above the removable panel.

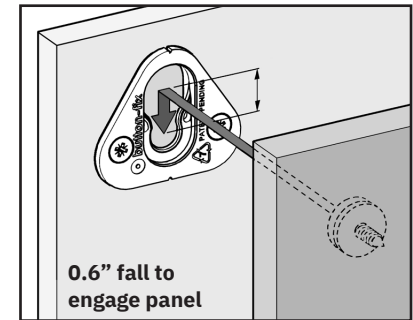
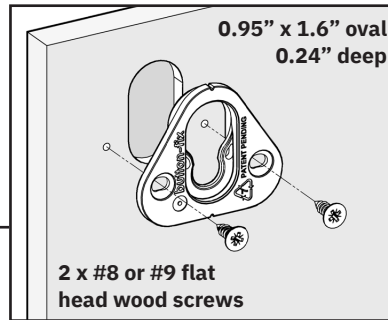

### 2. Fix on removable panel

The Fix is attached to the removable panel, pointing downwards as shown in the diagrams on the right.

In this configuration, the panels engage vertically and 0.6" clearance is required above the removable panel.

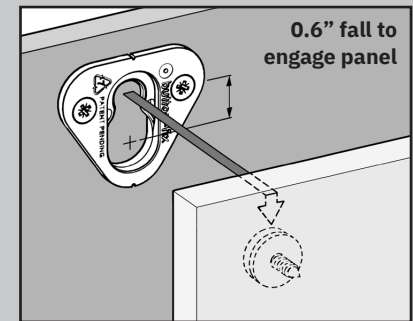
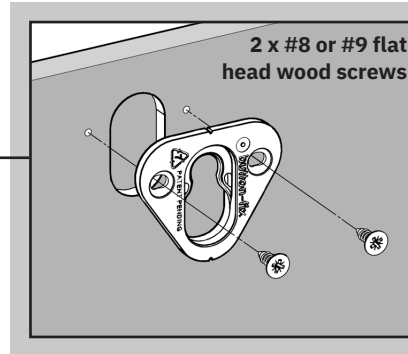

### 3. Sideways arrangement

The Fix is attached to either the background structure or the removable panel, pointing sideways as shown in the diagrams on the right.

In this configuration, the panels engage horizontally and 0.6" clearance is required to the side of the removable panel.

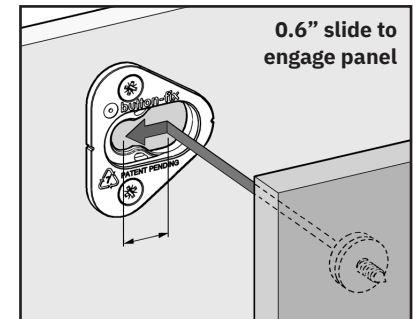
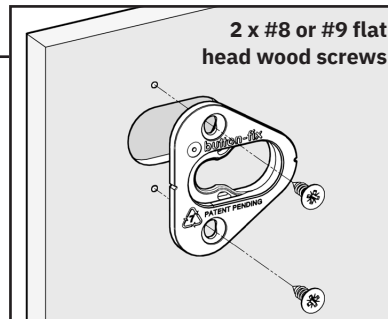

## A useful tip

When several Button-fixes are used on a panel, or if you require the panel to be easily removable, first try spraying the fixes with a PTFE or Silicone based lubricant spray.

The strength of the click-fit can be further reduced by adapting some (but not all) the Fix mouldings by snapping off the ears with needle-nosed pliers, as shown in the diagram on the right.

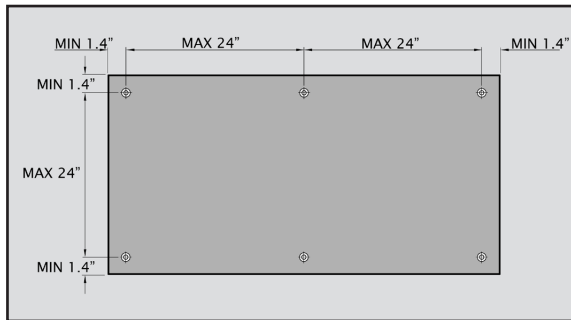
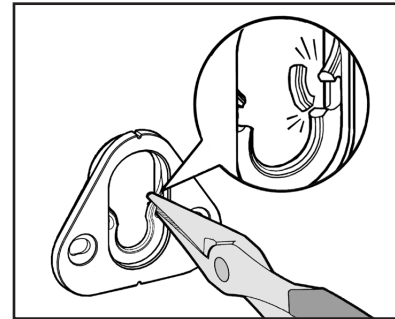

## Suggested layout

As an approximate guide, we suggest that Button-fix centres are no greater than 24" apart and no closer than 1.4" to the edge of the panel.

Always remember to allow at least 0.6" clearance for the removable panel to disengage.

## Router jig accessory

A router jig can be ordered separately for accurately machining the recesses for the Fixes, described on the previous page.

The jig is designed for use with a metric 12mm cutter and 16mm guide bush. Read the separate instructions supplied with the accessory before use.

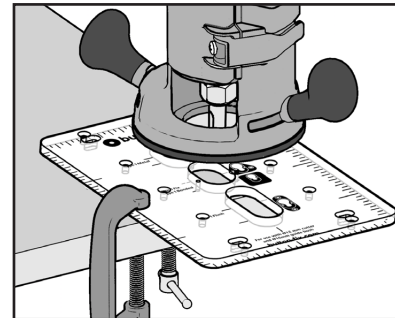

## Screw fixings guide 1/2

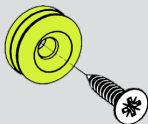
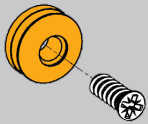
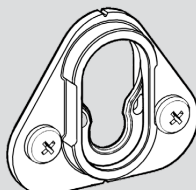
Product/configuration	Panel thickness/ material	Screw type	net thread length	Notes
<b>Button for flat head wood screw</b>  	<b>0.6" to 0.75" thick</b> Plywood, MDF, MFC	Ø5.0 × 20mm CSK (#10 × 0.75")	11.4mm	Spax or similar Timco (product code: 50020CLAF)
	<b>0.75" or greater</b> Plywood, MDF, MFC	Ø5.0 × 25mm CSK (#10 × 1")	16.4mm	Spax or similar. Screwfix (product code: 913PV) Timco (product code: 50025CLAF)
		M5 CSK machine screw (#10)		User-defined length e.g. M5 × 40mm Screwfix (product code: 7363J)
<b>Button for Varianta Euro screw</b>  	<b>0.4" to 0.5" thick</b> Plywood, MDF, MFC	Varianta Ø7.8 CSK × 13.5mm	6mm	Häfele America (product code: 013.51.724) <b>Requires Ø5mm pilot hole</b>
	<b>0.5" to 0.6" thick</b> Plywood, MDF, MFC	Varianta Ø7.8 CSK × 16mm	8.5mm	Häfele America (product code: 013.51.733) <b>Requires Ø5mm pilot hole</b>
<b>Surface-mounted Fix</b>  	<b>0.5" to 0.6" thick</b> Plywood, MDF, MFC	Ø4.0 × 12mm pan head (#8 × 0.5")	9mm	Use washers under screw heads
	<b>0.6" to 0.75" thick</b> Plywood, MDF, MFC	Ø4.5 × 16mm pan head (#9 × 0.625")	13mm	
	<b>0.75" or greater</b> Plywood, MDF, MFC	Ø5.0 × 20mm pan head (#10 × 0.75")	16.2mm	Use #10 / Ø5.0 screws for maximum strength
		M4 pan head machine screw (#8)		User-defined length
		M5 pan head machine screw (#10)		User-defined length. Tight fit but strong
	<b>Sheet metal</b>	Pop rivet or blind fixing Ø4.8mm roundhead		Rivet length to suit material thickness Use washers under rivet heads

Suggestions are based on screws available in the UK which have been tested for compatibility with Type 1 Button-fix. Screws from other suppliers may also be suitable but have not been validated by Buttonfix Limited – **always perform your own tests for critical applications.**

## Screw fixings guide 2/2

Product/configuration	Panel thickness/ material	Screw type	net thread length	Notes
<b>Surface-mounted Fix (continued)</b>	<b>0.4" to 0.5" thick</b> Plastic, HPL	#10 × 0.375" pan head Plas-Fix 60	6.4mm	TR Fastenings (product code: TR00032525-103) <b>Requires Ø4.75mm pilot hole</b>
	<b>0.5" to 0.6" thick</b> Plastic, HPL	#10 × 0.5" pan head Plas-Fix 60	9.5mm	TR Fastenings (product code: TR00032523-103) <b>Requires Ø4.75mm pilot hole</b>
<b>Recessed Fix</b> 	<b>0.6" to 0.75" thick</b> Plywood, MDF, MFC	Ø4.0 × 16mm CSK (#8 × 0.625")	14mm	
		Ø4.5 × 16mm CSK (#9 × 0.625")	12.8mm	
	<b>0.75" to 1" thick</b> Plywood, MDF, MFC	Ø4.5 × 20mm CSK (#8 × 0.75")	16.9mm	
		<b>1" or greater</b> Plywood, MDF, MFC	Ø4.5 × 25mm CSK (#8 × 1")	21.9mm
		M4 CSK machine screw (#8)		User-defined length
	<b>0.4" to 0.5" thick</b> Plastic, HPL	#8 × 0.375" CSK Plas-Fix 60	6.4mm	TR Fastenings (product code: TR00032436-103) <b>Requires Ø4.0mm pilot hole</b>
	<b>0.5" to 0.6" thick</b> Plastic, HPL	#8 × 0.5" CSK Plas-Fix 60	10mm	TR Fastenings (product code: TR00032434-103) <b>Requires Ø4.0mm pilot hole</b>
	<b>0.6" or greater</b> Plastic, HPL	Ø4.0 × 16mm CSK Plas-Tech 30	13.2mm	TR Fastenings (product code: TR00031910-103) <b>Requires Ø3.4mm pilot hole</b>
	<b>0.4" to 0.5" thick</b> Plywood, MDF, MFC	Varianta Ø 7.8 CSK × 10.5 mm	7.2mm	Häfele America (product code: 013.51.715) Tight fit but strong. <b>Requires Ø5.0mm pilot hole</b>
	<b>0.5" to 0.6" thick</b> Plywood, MDF, MFC	Varianta Ø 7.8 CSK × 13.5 mm	10.5mm	Häfele America (product code: 013.51.724) Tight fit but strong. <b>Requires Ø5.0mm pilot hole</b>
<b>0.6" or greater</b> Plywood, MDF, MFC	Varianta Ø 7.8 CSK × 16 mm	13mm	Häfele America (product code: 013.51.733) Tight fit but strong. <b>Requires Ø5.0mm pilot hole</b>	

## Specifications

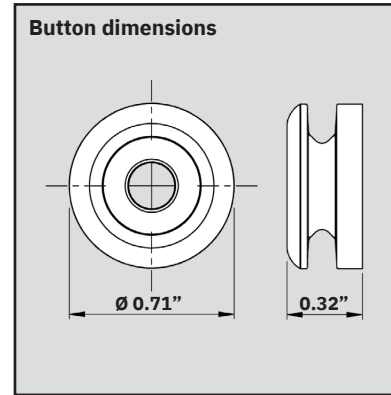
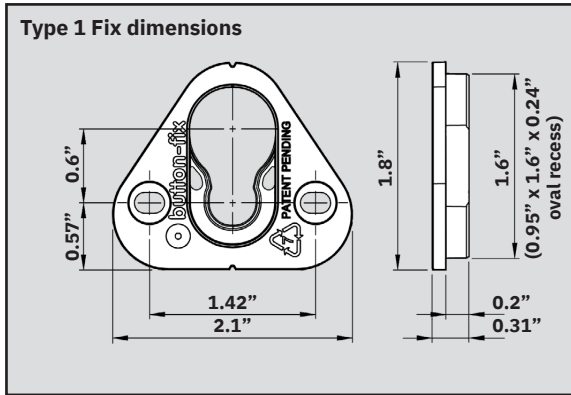

**Material:** Nylon PA6, 30% glass filled (Button & Fix)

**Guide loads:** Wall panel with 4 x Fixes = 440 lbs max.

Ceiling panel with 4 x Fixes = 250 lbs max.

—Advice on panel loads is given with the proviso that the screws and substrate are properly matched, and all other instructions complied with. For critical applications it is essential to perform your own tests.

—Advice is based on independent test reports, which can be found on our website:

[button-fix.com/technical-resources](http://button-fix.com/technical-resources)

**Origin:** Manufactured in the UK

**Buttonfix Limited**

Unit A, 1 Britton Street  
London, EC1M 5NW

**T: +44 (0)20 8150 7190**

**E: [info@button-fix.com](mailto:info@button-fix.com)**

**EU Authorised Representative:**

AR Experts BV  
Boeingavenue 209  
1119PD Schiphol-Rijk  
The Netherlands

**[button-fix.com](http://button-fix.com)**

Instructions for use  
—Type 1 Bonded Fix



## Type 1 bonded button-fix

The Button-fix concept is simple: the Fixes are attached to the back of one panel and the mating Buttons are attached to the other. Bring the panels together and slide until the Button-fixes 'click'.

The Type 1 Bonded Fix is moulded in ABS. It is designed for applications where screw-fixing to the panel is not possible and bonding is the preferred option. It can be configured in different ways to best suit your application, either surface-mounted or recessed into the panel, and orientated for vertical or sideways assembly.

Visit the website for more information on the complete Button-fix range, including videos of Button-fix in use. You can also obtain a new copy of these instructions from the website in the event of loss or in the event that Buttonfix modifies the instructions.

Buttonfix Limited retains the right to modify the instructions as it deems appropriate and the consumer is responsible for checking the website for the latest information.

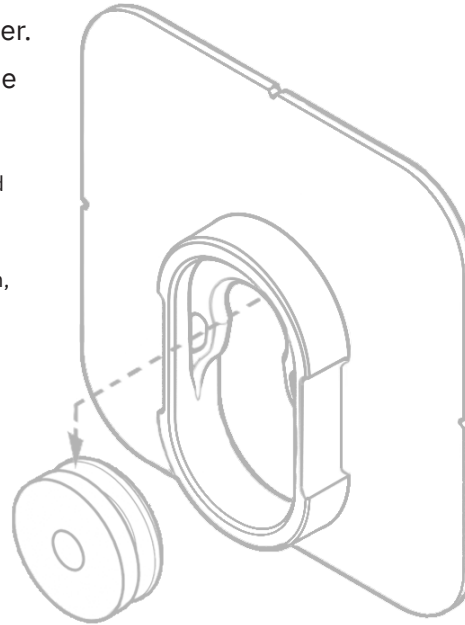

## Warnings

—Button-fix is intended for furniture construction and interior fittings and is not intended, nor should it be used, for any other purpose.

—**WARNING:** Serious damage to property and severe bodily injury can result from (1) improper use, application or installation of the Button-fix or (2) use as part of improperly designed or constructed assemblies or materials.

—**WARNING:** Use of adhesives other than the self-adhesive Fix-pads, 2-part structural acrylic adhesive, or solvent weld for bonding to acrylic, may not be effective for proper bonding of the Fix. Buttonfix disclaims any and all liability for use of adhesives other than the Fix-pads.

—Always follow the adhesive manufacturer's recommendations on substrate suitability, preparation and loadings, and perform your own tests as necessary.

—**CAUTION:** Please remember that many factors can affect the use and performance of the Fix-pads in a particular application. The materials to be bonded to the product, the conditions in which the product is used, and the time and environmental conditions in which the product is expected to perform are among the many factors that can affect the use and performance of the Fix-pads, some of which are uniquely within the consumer's knowledge and control. It is essential that the consumer evaluates the Fix-pad to determine whether it is fit for a particular purpose and suitable for the consumer's methods of application.

—When using the self-adhesive Fix-pads, we strongly advise that the Fixes are used in the rebated configuration. If Fix-pads are used in the surface-mounted configuration, the loading should be limited to a maximum of 4.4lbs per Fix.

—Avoid any contact with aggressive solvents and cleaning products.

—It is not possible for Buttonfix to warn the consumer about every possible danger related to use of the Button-fix and the consumer must use his or her own good judgment when installing and using the Button-fix.

## The button

There are two Buttons to suit different screw types. These are colour-coded lime green for #10 flat head wood screws, or orange for Ø6.2mm Varianta Euro screws (to fit Ø5mm pilot holes).

Check with your panel supplier which screw type is best for your application. You can find a guide to suggested screw sizes on page 8.

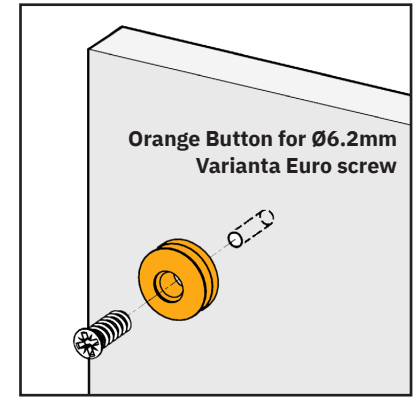
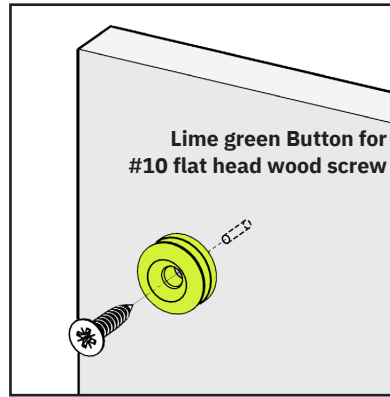

## Button marker accessory

The Button marker accessory helps to mark out where to install the Buttons.

Once you have attached the Fix mouldings (see following pages), snap a marker into each one. Then position the second panel and press firmly. The markers will leave indents in the panel surface, which can be used as guides for drilling pilot holes for the Buttons.

Remove the markers, which can be re-used to mark out the next panel.

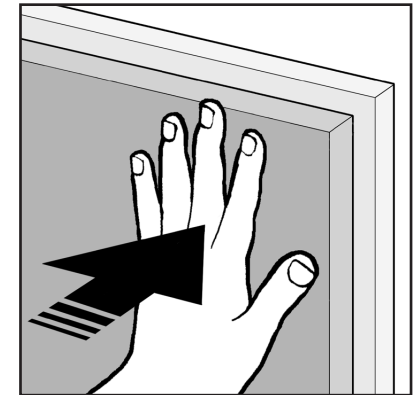
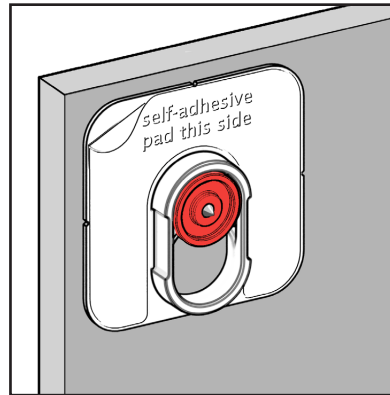

## Surface-mounted fix

For applications where it is not possible to machine the panel material, the Fix can be surface-mounted. This creates an 0.32" gap between the panel and the mounting surface.

Care must be taken to ensure the Fixes are correctly bonded to the panel.

**It is imperative that all the Fixes on a panel are aligned with each other. Use a square to check alignment.**

### Vertical arrangement

The Fix may be bonded to the removable panel in a vertical orientation, as shown in the left hand diagram.

In this configuration, the panels engage vertically and 0.6" clearance is required above the removable panel.

Note: the Fix should be inverted if it is bonded to the mounting surface.

### Sideways arrangement

The Fix may be bonded to either the removable panel or the mounting surface in a sideways orientation, as shown in the right hand diagram.

In this configuration, the panels engage horizontally and 0.6" clearance is required to the side of the removable panel.

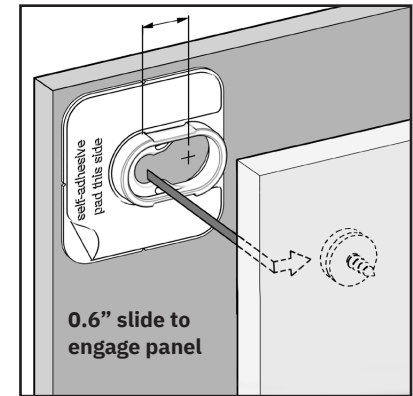
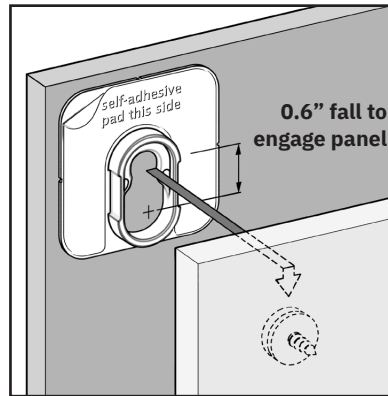
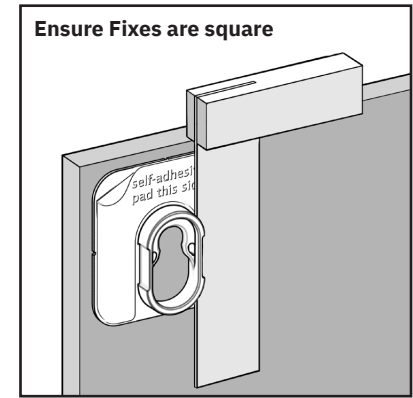
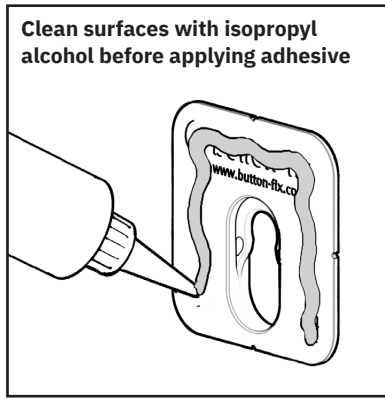

**Important: read the notes on page 7 regarding suitable adhesives and surface preparation.**

## Recessed fix

For applications where it is possible to machine a 0.28" deep recess in the panel, a stronger panel support can be achieved as the rebate supports the Fix in shear. The recess also helps to align the Fix while bonding.

Recessing the Fix creates a nominal 0.08" gap between the two panels

### Vertical arrangement

The Fix may be bonded to the removable panel in a vertical orientation, as shown in the left hand diagram.

In this configuration, the panels engage vertically and 0.6" clearance is required above the removable panel.

Note: the Fix should be inverted if it is bonded to the mounting surface.

### Sideways arrangement

The Fix may be bonded to either the removable panel or the mounting surface in a sideways orientation, as shown in the right hand diagram.

In this configuration, the panels engage horizontally and 0.6" clearance is required to the side of the removable panel.

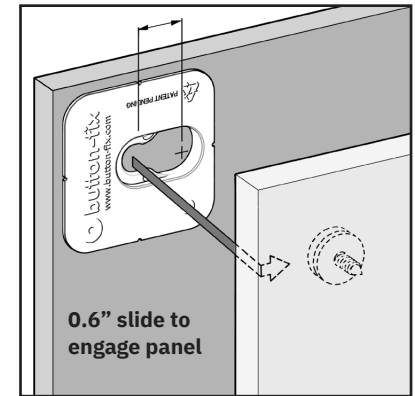
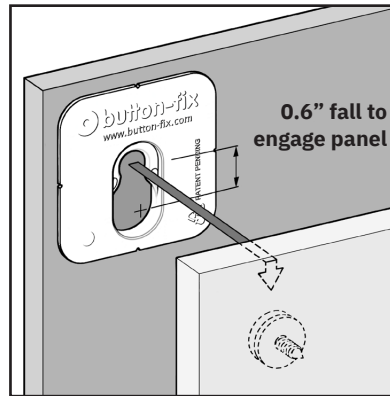
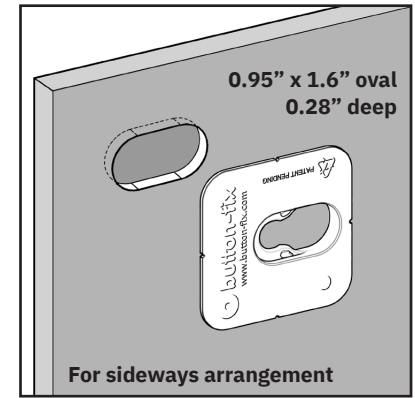
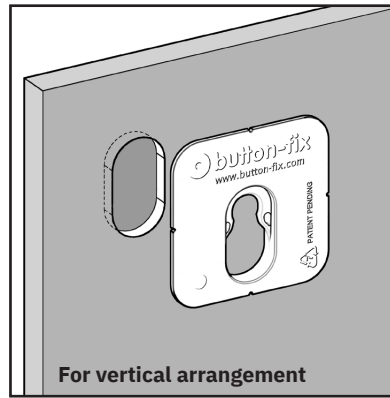

**Important: read the notes on page 7 regarding suitable adhesives and surface preparation.**

## Suitable adhesives

The Fix is manufactured in ABS plastic. There are many structural adhesives suitable for bonding it to a wide range of panel materials, e.g. a 2-part structural acrylic adhesive, a matched adhesive for solid surface (Corian®, Hanex®, etc.) or solvent weld for bonding to acrylic.

**Always follow the adhesive manufacturer's recommendations on substrate suitability, preparation and loadings.**

## Self-adhesive fix-pads

The Fix may also be bonded using self-adhesive Fix-pads (ordered separately).

We strongly advise that the self-adhesive Fix-pads are used in the recessed configuration, shown on the previous page, to avoid possible creep under loading.

If Fix-pads are used in the surface-mounted configuration, the loading should be limited to a maximum of 4.4lbs per Fix.

For best results when using Fix-pads, the surface of the Fix should be abraded using emery paper (180 grit) and both surfaces must be cleaned with isopropyl alcohol.

We highly recommend that the assembled Fixes be clamped to ensure good contact, and should not be fully loaded for at least 24 hours. At room temperature approximately 50% of ultimate bond strength will be achieved after 20 minutes, 90% after 24 hours and 100% after 72 hours.

**Abrade surface with emery cloth and clean with isopropyl alcohol**

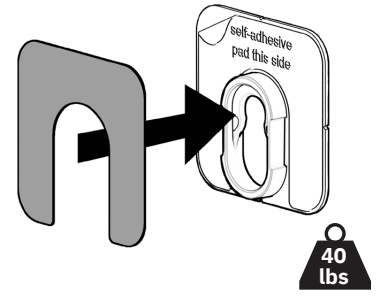

**Abrade surface with emery cloth and clean with isopropyl alcohol**

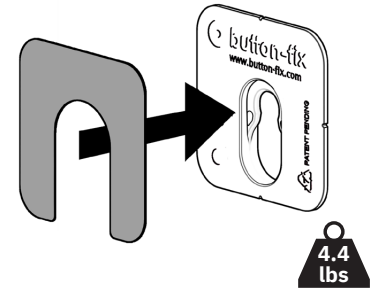

## Button screw fixings guide

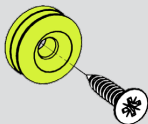
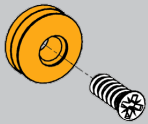
Product/configuration	Panel thickness/ material	Screw type	net thread length	Notes
<b>Button for flat head wood screw</b>  	<b>0.6" to 0.75" thick</b> Plywood, MDF, MFC	Ø5.0 × 20mm CSK (#10 × 0.75")	11.4mm	Spax or similar Timco (product code: 50020CLAF)
	<b>0.75" or greater</b> Plywood, MDF, MFC	Ø5.0 × 25mm CSK (#10 × 1")	16.4mm	Spax or similar. Screwfix (product code: 913PV) Timco (product code: 50025CLAF)
		M5 CSK machine screw (#10)		User-defined length e.g. M5 × 40mm Screwfix (product code: 7363J)
<b>Button for Varianta Euro screw</b>  	<b>0.4" to 0.5" thick</b> Plywood, MDF, MFC	Varianta Ø7.8 CSK × 13.5mm	6mm	Häfele America (product code: 013.51.724) <b>Requires Ø5mm pilot hole</b>
	<b>0.5" to 0.6" thick</b> Plywood, MDF, MFC	Varianta Ø7.8 CSK × 16mm	8.5mm	Häfele America (product code: 013.51.733) <b>Requires Ø5mm pilot hole</b>

Suggestions are based on screws available in the UK which have been tested for compatibility with Type 1 Button-fix. Screws from other suppliers may also be suitable but have not been validated by Buttonfix Limited – **always perform your own tests for critical applications.**

## A useful tip

When several Button-fixes are used on a panel, or if you require the panel to be easily removable, first try spraying the fixes with a PTFE or Silicone based lubricant spray.

The strength of the click-fit can be further reduced by adapting some (but not all) the Fix mouldings by snapping off the ears with needle-nosed pliers, as shown in the diagram on the right.

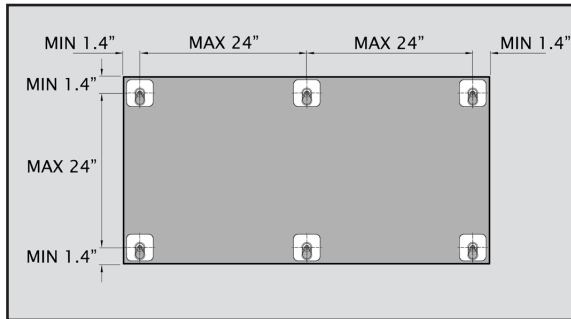
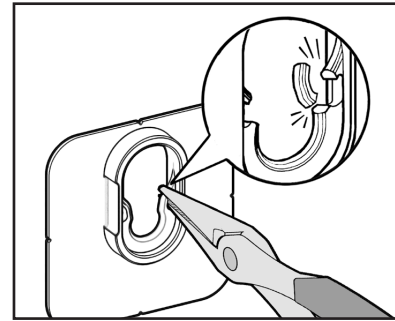

## Suggested layout

As an approximate guide, we suggest that Button-fix centres are no greater than 24" apart and no closer than 1.4" to the edge of the panel.

Always remember to allow at least 0.6" clearance for the removable panel to disengage.

## Router jig accessory

A router jig can be ordered separately for accurately machining the recesses for the Fixes, described on the previous page.

The jig is designed for use with a metric 12mm cutter and 16mm guide bush. Read the separate instructions supplied with the accessory before use.

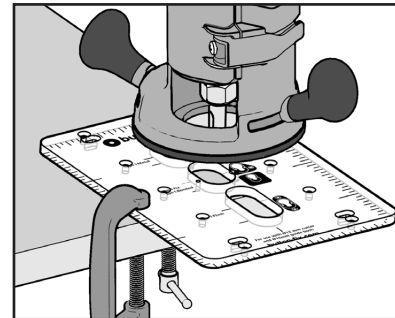

## Specifications

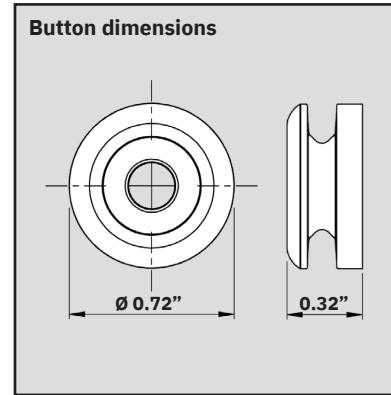
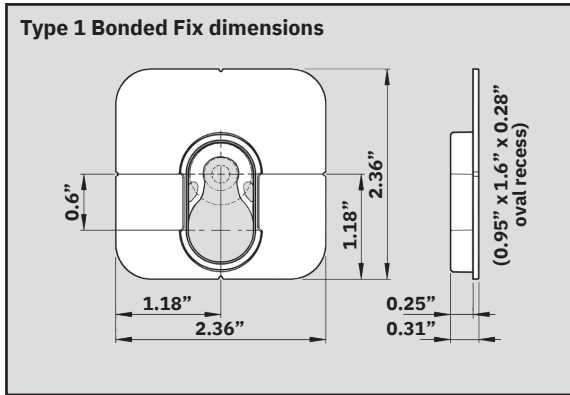

**Material:** ABS (Fix) & Nylon PA6, 30% glass filled (Button)

**Guide loads:** Wall panel with 4 x Fixes = 160 lbs max.

Ceiling panel with 4 x Fixes = 160 lbs max.

—Always follow the adhesive manufacturer's recommendations on substrate suitability, preparations and loadings, and perform your own tests as necessary.

—Independent test reports for specific materials can be found on our website:

[button-fix.com/technical-resources](http://button-fix.com/technical-resources)

**Origin:** Manufactured in the UK

**Buttonfix Limited**  
Unit A, 1 Britton Street  
London, EC1M 5NW

**T:** +44 (0)20 8150 7190

**E:** [info@button-fix.com](mailto:info@button-fix.com)

**EU Authorised Representative:**

AR Experts BV  
Boeingavenue 209  
1119PD Schiphol-Rijk  
The Netherlands

[button-fix.com](http://button-fix.com)



# MBS-Standoffs

 **button-fix**  
Panel fixing made easy

**Instructions for use**  
**—Type 1 Flush Fix**



## Type 1 flush button-fix

The Button-fix concept is simple: durable Fixes are attached to the back of one panel and the mating Buttons are attached to the other. Bring the panels together and slide until the Button-fixes ‘click’.

The Type 1 Flush Button-fix is moulded in glass-reinforced nylon. It is designed for applications where panel-panel contact is required and fits a simple oval rebate. It can be rebated into the edge of a panel of at least 28mm thick or the face of a panel of at least 18mm thick, and orientated for vertical or sideways assembly.

Visit the website for more information on the complete Button-fix range, including videos of Button-fix in use. You can also obtain a new copy

of these instructions from the website in the event of loss or in the event that Buttonfix modifies the instructions.

Buttonfix Limited retains the right to modify the instructions as it deems appropriate and the consumer is responsible for checking the website for the latest information.

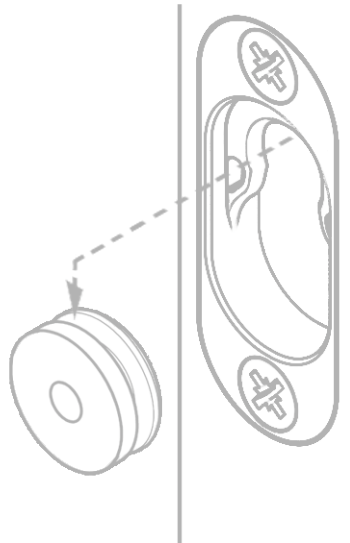

## Warnings

—Button-fix is intended for furniture construction and interior fittings and is not intended, nor should it be used, for any other purpose.

—**WARNING:** Serious damage to property and severe bodily injury can result from (1) improper use, application or installation of the Button-fix or (2) use as part of improperly designed or constructed assemblies or materials.

—Provided that the screws and substrate are properly matched, and all other instructions complied with, tests showed that a vertical panel fixed with four Type1 Flush Fixes can support loads weighing up to a maximum of 100kg (220lbs). For critical applications it is essential to perform your own tests.

—Avoid any contact with aggressive solvents and cleaning products.

—It is not possible for Buttonfix to warn the consumer about every possible danger related to use of the Button-fix and the consumer must use his or her own good judgment when installing and using the Button-fix.

## The button

There are two Buttons to suit different screw types. These are colour-coded lime green for  $\varnothing 5\text{mm}$  countersunk wood screws, or orange for  $\varnothing 6.2\text{mm}$  Varianta Euro screws (to fit  $\varnothing 5\text{mm}$  pilot holes).

Check with your panel supplier which screw type is best for your application.

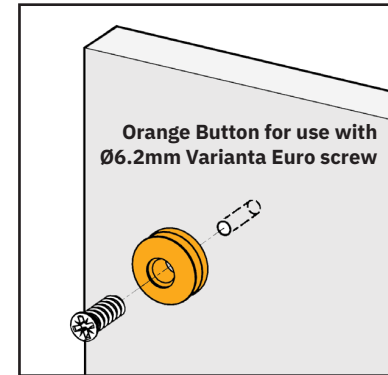
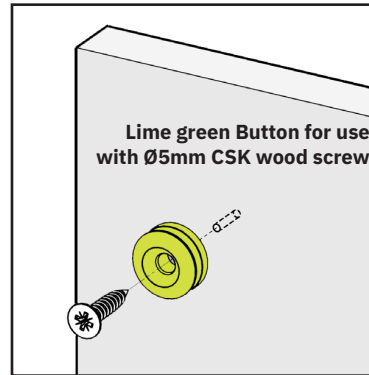

## Button marker accessory

The Button marker accessory helps to mark out where to install the Buttons.

Once you have attached the Fix mouldings (see following pages), insert a marker into each one. Then position the second panel and press firmly. The markers will leave indents in the panel surface, which can be used as guides for drilling pilot holes for the Buttons.

Remove the markers, which can be re-used to mark out the next panel.

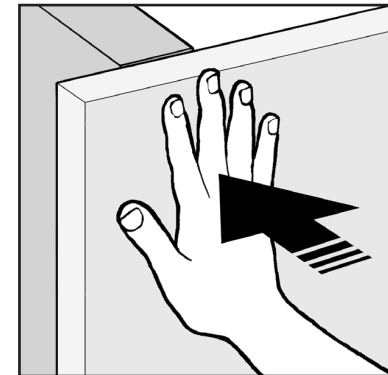
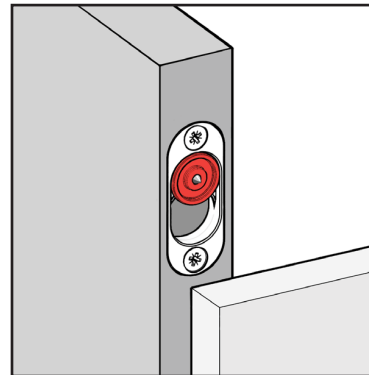

## Rebated fix

### 1. Edge-rebated fix

The Type 1 Flush Fix may be rebated into the edge of a panel of at least 28mm thickness. An oval rebate measuring 22 x 56 x 8.1mm is required.

**Ensure the 8.1mm depth of the cutter is accurately set on the router.**

2 x Ø4.5mm countersunk wood screws at least 25mm long are required.

The Fix may be installed either way up depending on the application.

### 2. Face-rebated fix

The Fix may be rebated into the face of a panel of at least 18mm thickness.

An oval rebate measuring 22 x 56 x 8.1mm is required. As above, the accuracy of the 8.1mm depth of the rebate is highly important.

The Fix may be installed either way up, or orientated horizontally or vertically, depending on the application.

## Surface-mounted fix

In some circumstances you may chose not to rebate the Fix. This creates an 8mm gap between the panels.

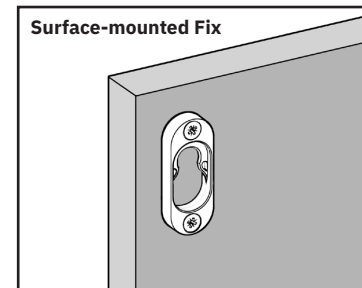
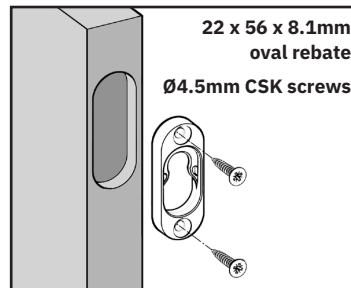
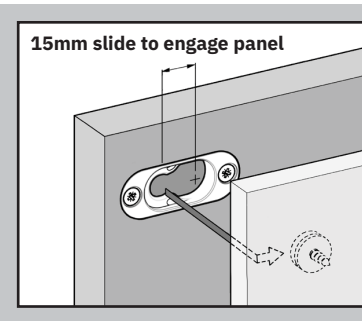
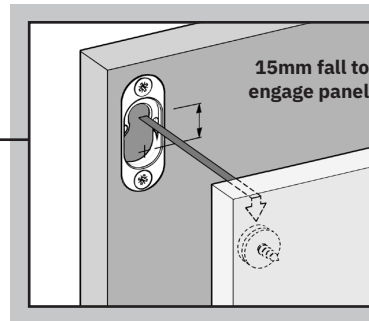
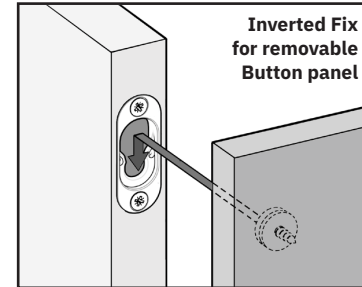
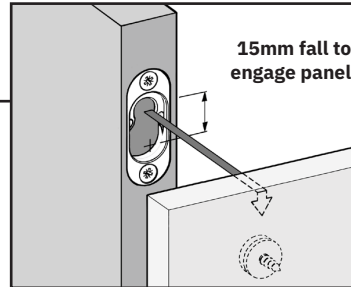

## A useful tip

When several Button-fixes are used on a panel, or if you require the panel to be easily removable, first try spraying the fixes with a PTFE or Silicone based lubricant spray.

The strength of the click-fit can be further reduced by adapting some (but not all) the Fix mouldings by snapping off the ears with needle-nosed pliers, as shown in the diagram on the right.

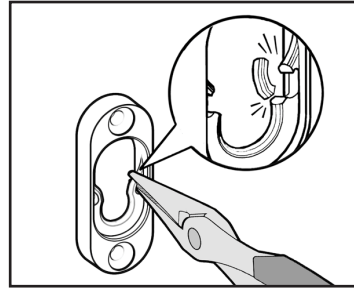

## Suggested layout

As an approximate guide, we suggest that Button-fix centres are no greater than 600mm apart and no closer than 14mm to the edge of the panel.

A Fix may also be rebated into the edge of a panel with a minimum thickness of 28mm.

Always remember to allow at least 15mm clearance for the removable panel to disengage.

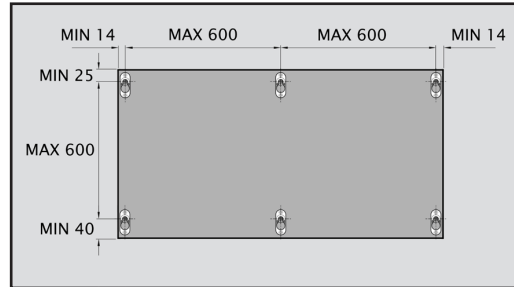

## Router jig accessory

A router jig can be ordered separately for accurately machining the rebates for the Fixes, described on the previous page.

The jig is designed for use with a metric 12mm cutter and 16mm guide bush. Read the separate instructions supplied with the accessory before use.

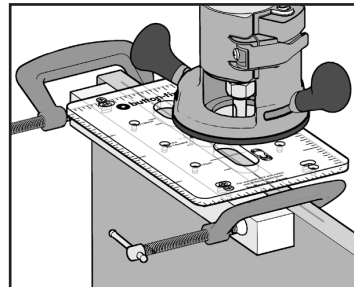

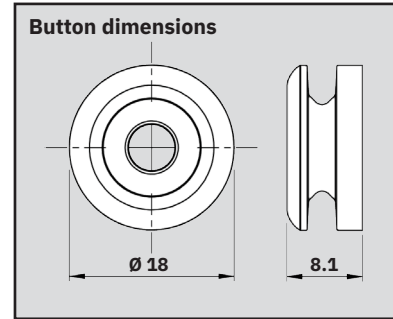
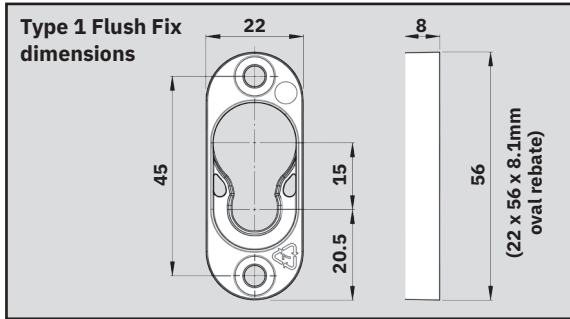

## MBS-Standoffs

### Our Warehouse Locations

5046 W Linebaugh Ave  
Tampa, FL, 33624

8375 Eastgate Rd  
Henderson NV, 89015

941 Enterprise Ct  
St Charles IL, 60174

7084 S Revere Pkwy  
Centennial CO, 80112



Any Question?

Call Us! 1 (813) 938-6025

sales@mbs-standoffs.com

www.mbs-standoffs.com

Instructions for use  
—Type 1 Metal Fix



## Type 1 metal button-fix

The Button-fix concept is simple: the Fixes are attached to the back of one panel and the mating Buttons are attached to the other. Bring the panels together and slide until the Button-fixes 'click'.

The Type 1 Metal Button-fix is diecast in zinc alloy and fitted with a stainless steel spring. It connects parallel panels and its strength has been verified by an independent test house. It can be configured in many different ways to best suit your application, either surface-mounted or rebated into the panel, and orientated for vertical or sideways assembly.

Visit the website for more information on the complete Button-fix range, including videos of the Type 1 Metal Button-fix in use. You can also obtain

a new copy of these instructions from the website in the event of loss or in the event that Buttonfix modifies the instructions.

Buttonfix Limited retains the right to modify the instructions as it deems appropriate and the consumer is responsible for checking the website for the latest information.

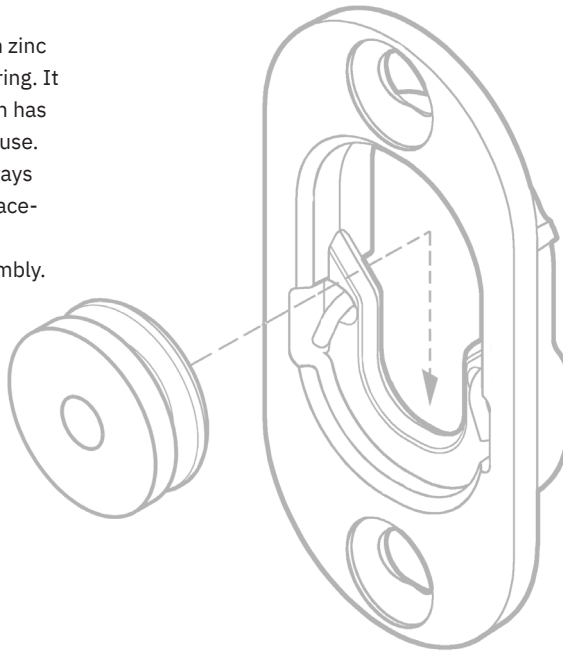

## Warnings

—Button-fix is intended for furniture construction and interior fittings and is not intended, nor should it be used, for any other purpose.

—**WARNING:** Serious damage to property and severe bodily injury can result from (1) improper use, application or installation of the Button-fix or (2) use as part of improperly designed or constructed assemblies or materials.

—Provided that the screws and substrate are properly matched, and all other instructions complied with, independent tests showed that a vertical panel fixed with four Type 1 Metal Fixes can support loads weighing up to a maximum of 350kg (770lbs). For critical applications it is essential to perform your own tests.

—Avoid any contact with aggressive cleaning products.

—It is not possible for Buttonfix to warn the consumer about every possible danger related to use of the Button-fix and the consumer must use his or her own good judgment when installing and using the Button-fix.

## The button

The Button is designed to suit different screw types: Ø5mm countersunk wood screws, M5 machine screws, or Ø6.2mm Varianta Euro screws (to fit Ø5mm pilot holes).

Check with your panel supplier which screw type is best for your application.

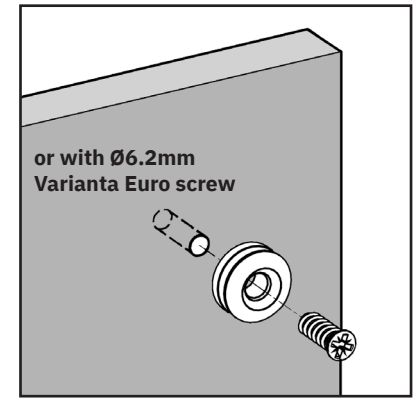

## Button marker accessory

The Button marker accessory helps to mark out where to install the Buttons.

Once you have attached the Fixes (see following pages), insert a marker into each one. Then position the second panel and press firmly: the markers will leave indents in the panel surface, which can be used as guides for drilling pilot holes for the Buttons.

Remove the markers, which can be re-used to mark out the next panel.

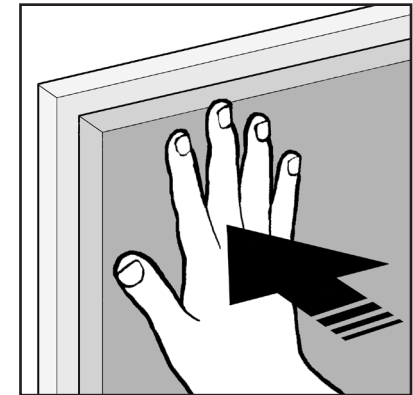
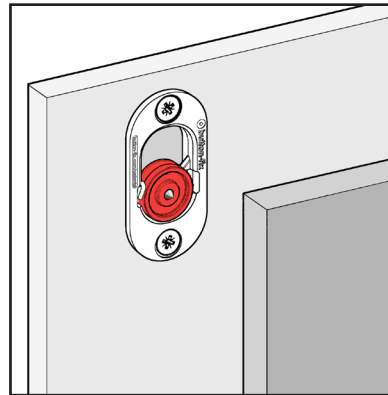

## Surface-mounted fix

Surface mounting creates an 8mm gap between the two panels. The Fix can be configured in three options:

### 1. Button on removable panel

The Fix is attached to the background structure, pointing upwards as shown in the diagrams on the right.

In this configuration, the panels engage vertically and 15mm clearance is required above the removable panel.

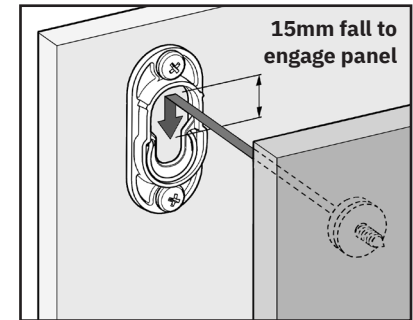
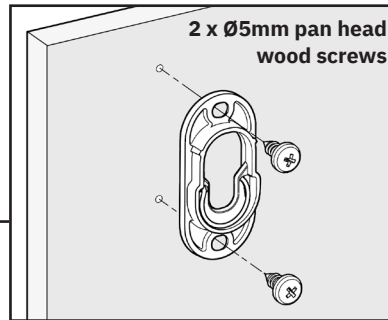

### 2. Fix on removable panel

The Fix is attached to the removable panel, pointing downwards as shown in the diagrams on the right.

In this configuration, the panels engage vertically and 15mm clearance is required above the removable panel.

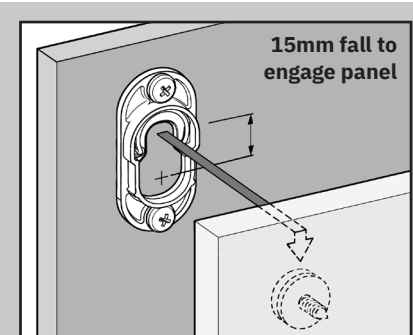
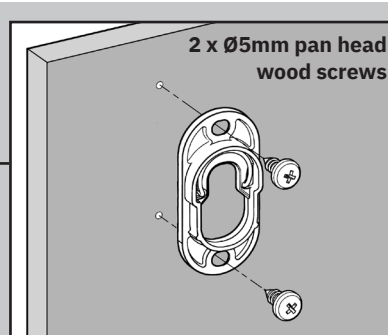

### 3. Sideways arrangement

The Fix is attached to either the background structure or the removable panel, pointing sideways as shown in the diagrams on the right.

In this configuration, the panels engage horizontally and 15mm clearance is required to the side of the removable panel.

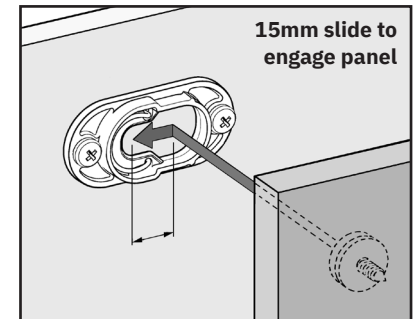
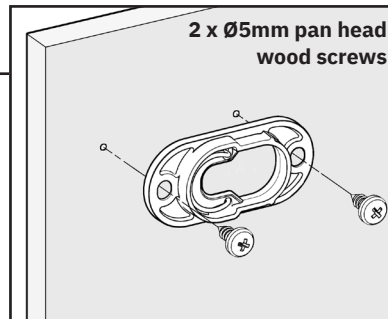

## Rebated fix

Rebating the Fix creates a 3mm gap between the two panels. The Fix can be configured in three options:

### 1. Button on removable panel

The Fix is attached to the background structure, pointing upwards as shown in the diagrams on the right.

In this configuration, the panels engage vertically and 15mm clearance is required above the removable panel.

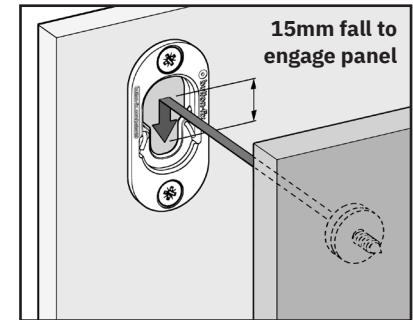
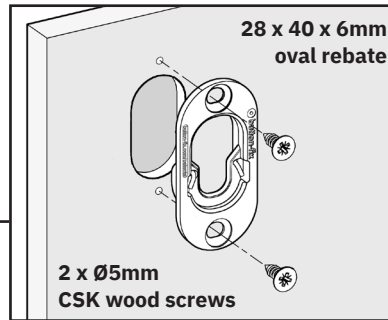

### 2. Fix on removable panel

The Fix is attached to the removable panel, pointing downwards as shown in the diagrams on the right.

In this configuration, the panels engage vertically and 15mm clearance is required above the removable panel.

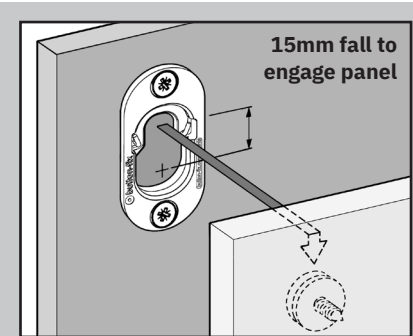
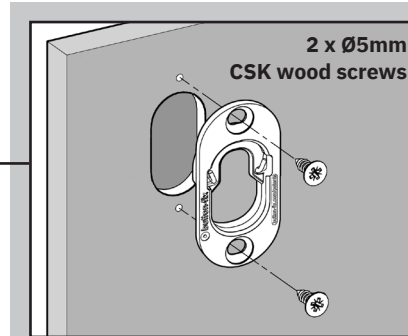

### 3. Sideways arrangement

The Fix is attached to either the background structure or the removable panel, pointing sideways as shown in the diagrams on the right.

In this configuration, the panels engage horizontally and 15mm clearance is required to the side of the removable panel.

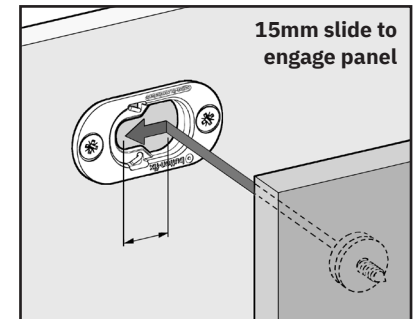
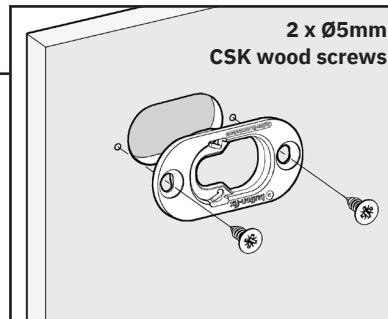

## Suggested layout

As an approximate guide, we suggest that Button-fix centres are no greater than 600mm apart.

Always remember to allow at least 15mm clearance for the removable panel to disengage.

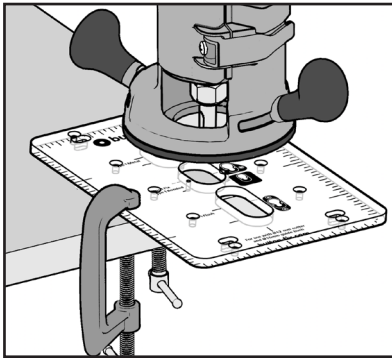
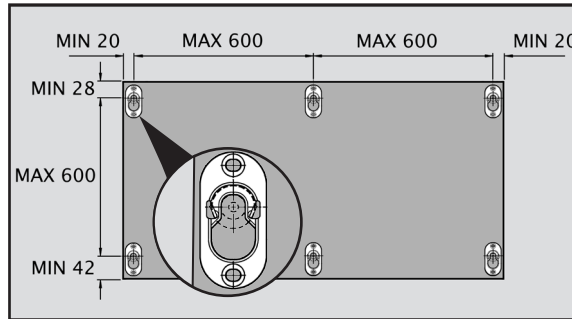

## Router jig accessory

A router jig can be ordered separately for accurately machining the rebates for the Fixes, described on the previous page.

The jig is designed for use with a metric 12mm cutter and 16mm guide bush. Read the separate instructions supplied with the accessory before use.

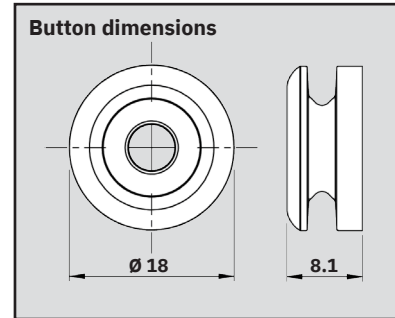
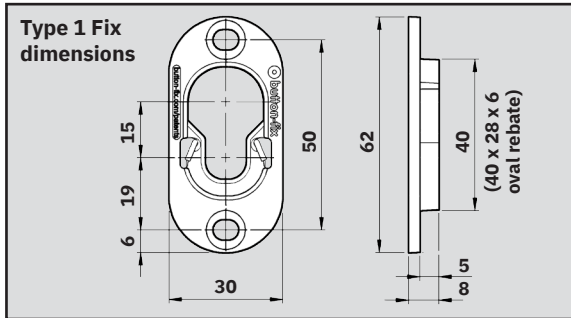

**Manufactured in the UK**

**Buttonfix Limited**  
**Unit A, 1 Britton Street**  
**London, EC1M 5NW**

**T: +44 (0)20 8150 7190**

**E: [info@button-fix.com](mailto:info@button-fix.com)**

**[button-fix.com](http://button-fix.com)**

